

3348005

**\$75,000USD**

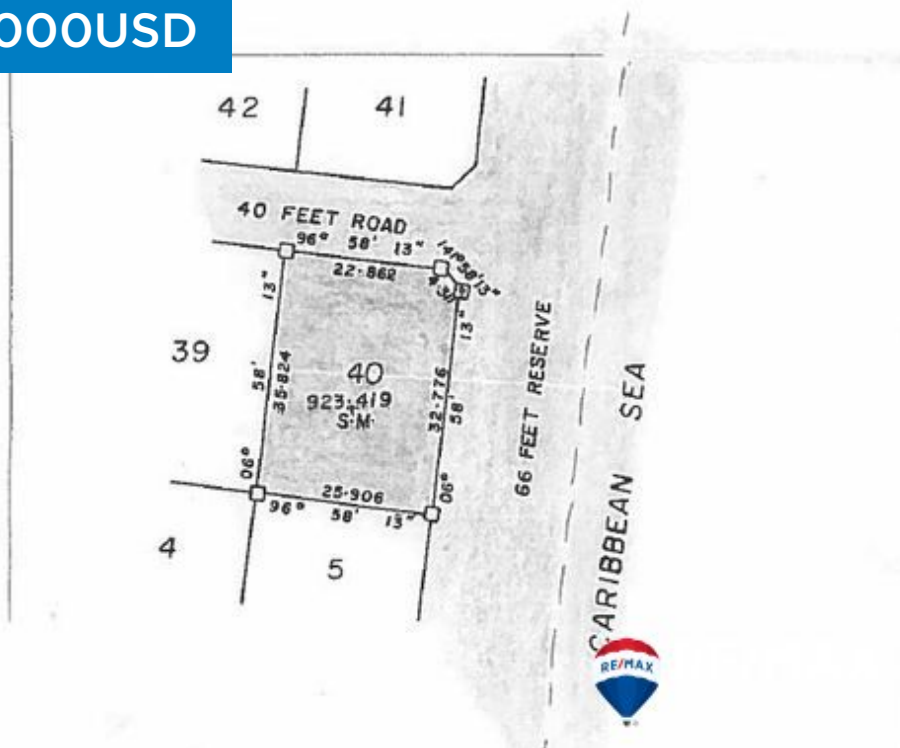

## L7400 - 108ft of pristine Beachfront

Location: Punta Gorda - Punta Negra - Toledo

Land Area: 9929 | Frontage: Beach-Front

This 108 feet of pristine beachfront property is located in Punta Negra, just north of Punta Gorda in the Toledo District. Toledo District is truly a destination unto itself. Near the Payneâ€™s Creek National Park - In between Punta Negra Lake & Sabal Beach. If you are looking for a fantastic beachfront location to establish a hospitality business or private estate in Sothern Belize. This property would be suited for residential development. There is no electricity or water as yet. Call today to schedule a private tour.



Agent: Kyle Young  
E-Mail: [kyle@1stchoicebelize.com](mailto:kyle@1stchoicebelize.com)  
Mobile: +(501) 615-3644  
Phone: +(501) 523-3666



RE/MAX 1st Choice  
Main Road  
Placencia & Hopkins Village  
Stann Creek, Belize Central America