

\$37,750USD

GRID U. T. M. ZONE 18 N METRES	UTM EASTING	UTM NORTHING
18 N 1	200 000.000	1863 100.000
18 N 2	200 000.000	1863 100.000
18 N 3	200 000.000	1863 100.000
18 N 4	200 000.000	1863 100.000
18 N 5	200 000.000	1863 100.000
18 N 6	200 000.000	1863 100.000

REGISTRATION	ACQUISITION	DATE
DATE ACQUISITION	16126	13/11/2015
LOT NO.	14	

SURVEYED BY: *M. Sanchez* DATE: *January 12, 2016*
M. E. SANCHEZ (Lic. Land Sur.)
Licensed Land Surveyor

DETAIL PLAN
Scale 1/1,000

Scale: 1/10,000

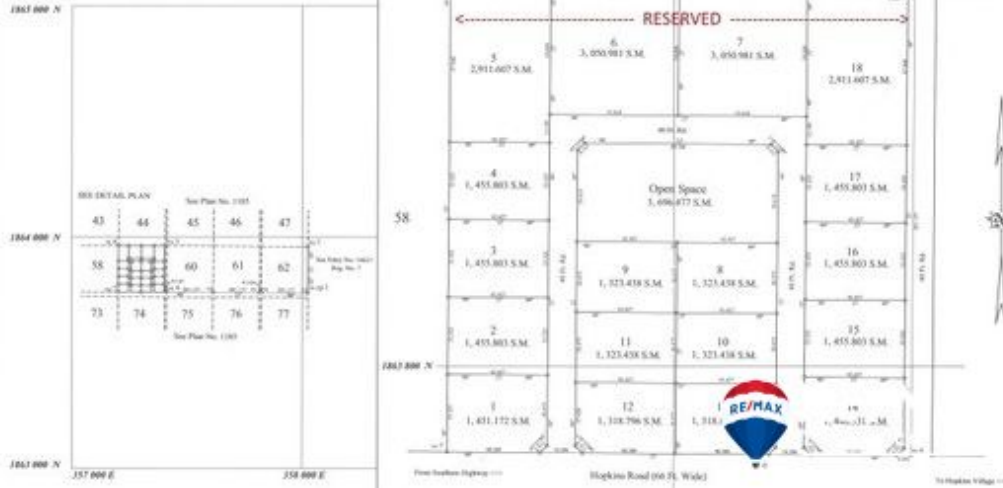

L2025 - Nice Size Lots, Hopkins Road, less than 5 Miles to the Sea with Owner financing

Location: Hopkins - Stann Creek

Frontage: Road-Front

We are happy to announce a new subdivision on Hopkins Road less than 5 miles from the Caribbean Sea. SELLER FINANCING AVAILABLE WITH LITTLE MONEY DOWN Lots start at .3 of an acre to .75 acres. Hopkins Road Lots 1,12,13 are \$52,500.00 Interior Lots 2,3,4, 8,9,10,11,15,16,17 are \$45,750.00 Interior Lots 3,4,16,17 are \$37,750.00 Back .75 Acre Lots 1,12,13,14 are \$69,900.00



Agent: David Kafka
E-Mail: david@1stchoicebelize.com
Mobile: +(501) 615-7653
Phone: +(501) 523-3666



RE/MAX 1st Choice
Main Road
Placencia & Hopkins Village
Stann Creek, Belize Central America